

SR.NO.	DESCRIPTION	NOMINAL RATIO	ACTUAL RATIO	NOMINAL POWER	RPM	QTY.
1	XC25-R11-H11-R10-73-436	10:1	9.80:1	358 KW	1500	1
2	XC25-R11-H11-R14-73-436	14:1	13.4:1	276 KW	1500	1
3	XC25-R11-H11-R18-73-436	18:1	17.1:1	215 KW	1500	1

NOTE:
 SHAFT ENDS WITH KEYS ACCORDING TO DIN 6885, PART-1, SHAPE-A.
 SHAFT CENTERING ACCORDING TO DIN - 332 DS WITH THREADS.
 DIRECTION OF ROTATION OF OUTPUT SHAFT LOOKING TOWARDS ITS ENDS.
 DIMENSIONS CERTIFIED FOR CONSTRUCTION.
 APPROX. TOTAL WEIGHT WITHOUT OIL - 730 KGS.
 REQUIRED APPROX. OIL QUANTITY PER GEAR BOX : 40LITRS.
 LUBRICATING OIL: SERVOMESH SP 320 OR EQUI.

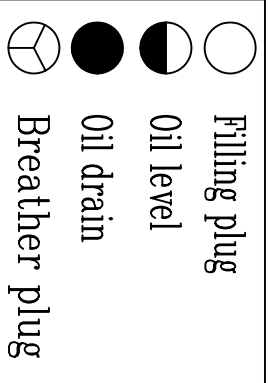
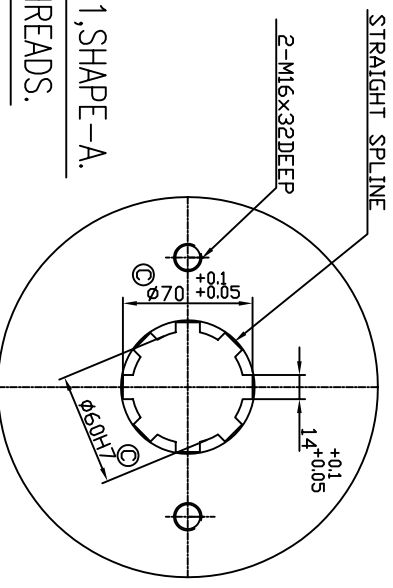
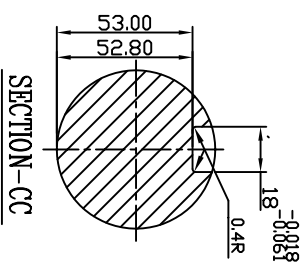

PERMISSIBLE DEVIATION FOR UNMACHINED LINEAR DIMENSIONS:

0.5-8	± 0.2	± 0.3	± 0.5	± 0.8	± 1.2
8-30	± 0.3	± 0.4	± 0.6	± 1.0	± 1.5
30-120	± 0.4	± 0.5	± 0.7	± 1.1	± 1.6
120-400	± 0.5	± 0.6	± 0.8	± 1.2	± 1.7
400-1000	± 0.6	± 0.7	± 0.9	± 1.3	± 1.8
1000-2000	± 0.7	± 0.8	± 1.0	± 1.4	± 1.9

PERMISSIBLE DEVIATION OF ANGULAR DIMENSIONS (shorter side of angle):

0-10	± 12'
10-30	± 10'
30-60	± 8'
60-90	± 7'
90-120	± 6'
120-180	± 5'
180-270	± 4'
270-360	± 3'

SR.NO.	DESCRIPTION	DATE	APPROVED	SCALE	ORDER NO.
A	010-0408 DRAWING CHANGED AS PER CLIENT REQUIREMENT.	26.2.07	N. G. GANDUPE	1	SENMAK
B	100-0408 DRAWING CHANGED AS PER CLIENT REQUIREMENT.	26.2.07	N. G. GANDUPE		
C	240-0408 DRAWING CHANGED AS PER CLIENT REQUIREMENT.	26.2.07	N. G. GANDUPE		

ELEGON 516-00-1213

DRG. NO. : 516-00-1213

ISSUE

THIS DRG. IS PROPERTY OF ELEGON ENGINEERING. LOANED TO THE RECIPIENT WHO AGREES THAT IT SHOULD NOT BE GIVEN OUT COPIED OR DUPLICATED FOR THE USE OF OTHERS BUT ONLY USED BY THE RECIPIENT FOR THE PURPOSE OF MAINTAINING THE EQUIPMENT TO WHICH IT RELATES.